

# STAR CASE DESIGNER SERIES WARDROBE CLOSET ORGANIZATION STORAGE SYSTEM

## Detailed Assembly Instructions with PVC or smoked acrylic side and cover panels

Care must be taken during the assembly process to insure proper fit of the smoked acrylic panels within the extruded frame rails. Use of a #2 magnetic tipped philips head hand screwdriver will help to avoid marring acrylic panels. Please follow these instructions carefully. For safety purposes and ease of assembly, we recommend a large flat area and the help of an assistant.

### Step 1

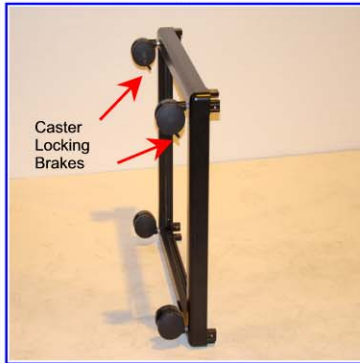

Place preassembled bottom frame with casters on flat surface or floor - position as shown in "Step 1" photo. NOTE: make sure casters with locking brakes are on top of the preassembled frame

### Step 2



Place first aluminum rail on flat surface. Check to confirm that this rail has no hinges or magnetic catches. See step 3 & 25 for IMPORTANT NOTE regarding vertical rail installation.

### Step 3

#### IMPORTANT NOTE!!

All vertical aluminum rails have pre-installed shelf support brackets positioned in their upper half. When installing the 4 vertical aluminum rails, be sure these brackets are in the upper half of the rail. THIS IS VERY IMPORTANT AND WILL AVOID HAVING TO DISASSEMBLE AND REASSEMBLE YOUR WARDROBE CLOSET. SEE STEP 25 FOR IMPORTANT DETAILS.

### Step 4



Line up slot openings in end of aluminum rail with the two exposed stubs of connecting cast corner. Position threaded aluminum rail over stubs and check threaded hole in each stub is in line with pre-drilled holes of aluminum rail.

### Step 5

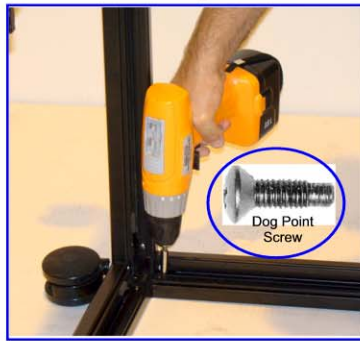

Next insert dog point screw through pre-drilled hole and into threaded hole of stub and fasten securely. Repeat for second stub.

### Step 6



Position, line up & insert 1/8" back panel with 1/8" slot in aluminum rail & corresponding 1/8" slot in preassembled bottom frame. NOTE: For a secure fit each acrylic panel has 2 foam strips attached. Please see step 24 for details.

### Step 7



Acrylic back panel inserted in 1/8" slot in aluminum rail & corresponding 1/8" slot in preassembled bottom frame.

### Step 8

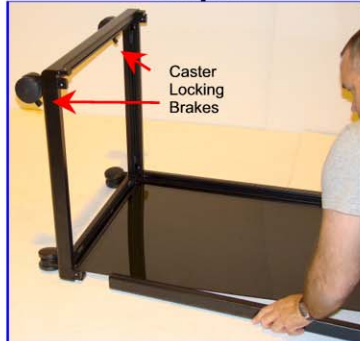

Place second aluminum rail on flat surface. Please check to confirm that this rail has no hinges or magnetic catches. See step 3 & 25 for IMPORTANT NOTE regarding vertical rail installation. Repeat steps 4 & 5.

### Step 9

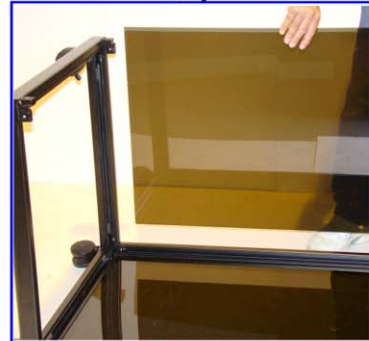

Position, line up & insert 1/8" left side panel with 1/8" slot in aluminum rail & corresponding 1/8" slot in preassembled bottom frame. NOTE: For a secure fit each acrylic panel has 2 foam strips attached. Please see step 24 for details.

**Star Case Manufacturing Co., Inc.**

648 Superior Ave. - Munster, IN 46321  
Ph: (219)922-4440 FX: (219)922-4442

(800)822-STAR (7827)

(800)782-CASE (2273)

email: [star@starcas.com](mailto:star@starcas.com)

[www.starcas.com](http://www.starcas.com)

### Step 10

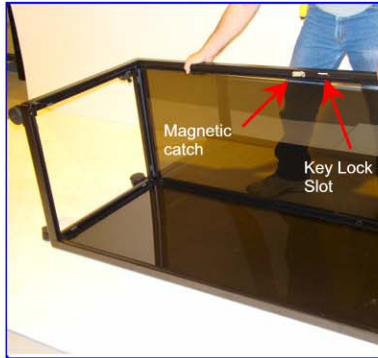

Place third aluminum rail (rail with magnetic catch & key lock slot) into position above left acrylic side panel. NOTE: Magnetic catch must be below key lock slot. Check that side panel lines up and insert into 1/8" slot of aluminum rail and 1/8" slot in bottom frame. Please see step 3 & 25 for IMPORTANT NOTE regarding vertical rail installation. Repeat steps 4 & 5.

### Step 11



Position, line up & insert 1/8" right side panel with 1/8" slot in aluminum rail & corresponding 1/8" slot in preassembled bottom frame. NOTE: For a secure fit each acrylic panel has 2 foam strips attached. Please see step 24 for details.

### Step 12

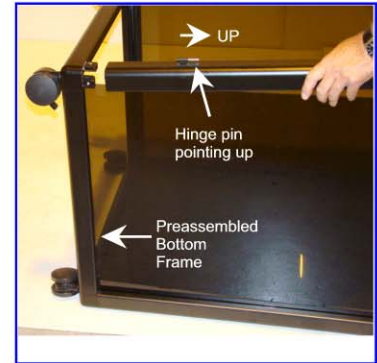

Place fourth aluminum rail into position as shown. Check that side panel lines up & insert into 1/8" slot of vertical rail and 1/8" slot in bottom frame. Please check to confirm hinges are positioned on this rail and hinge pins are pointing UP and away from preassembled bottom frame. See step 3 & 25 for IMPORTANT NOTE regarding vertical rail installation. Repeat steps 4 & 5.

### Step 13

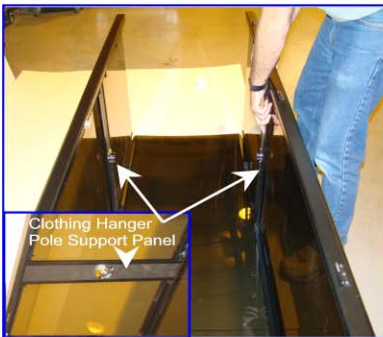

Install clothing hanger pole support panel between support brackets pre-installed in both front & rear vertical rails on left and right side as shown. NOTE: See step 26 for important details.

### Step 14



Position preassembled top frame as shown, line up all eight stubs with the eight slot openings of the four vertical rails. Position rail over stubs and check that holes in each stub are in line with pre-drilled holes in end of aluminum rails. Insert stubs securely. Next insert dog point screw through pre-drilled hole and into threaded hole of stub and fasten securely. Repeat for all eight stubs at all four corners.

### Step 15



Carefully lift and tilt assembled structure to full upright position, preferably with the help of an assistant.

### Step 16



Position clothing hanger pole into left side circular support.

### Step 17

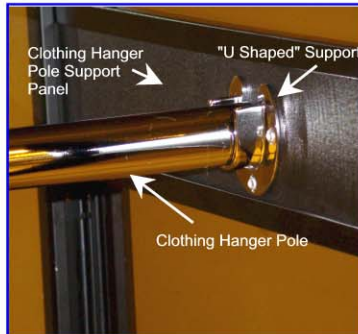

Position clothing hanger pole into right side "U shaped" support.

### Step 18

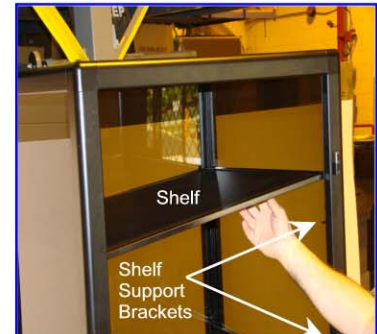

Position and set in place two upper shelves onto pre-installed support brackets.



**Step 19**  
Position and set in place bottom shelf into pre-assembled bottom frame.



**Step 20**  
Place and line up front door frame female hinges over male hinge pins until in complete resting position. See step 21 for details.

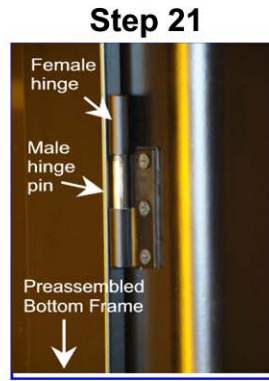

**Step 21**  
Line up male hinge pins attached to outer surface of right vertical rail with corresponding female hinge openings attached to back of right surface of door frame. Once all male hinge pins are aligned with all female openings press down gently until door frame is in complete resting position.

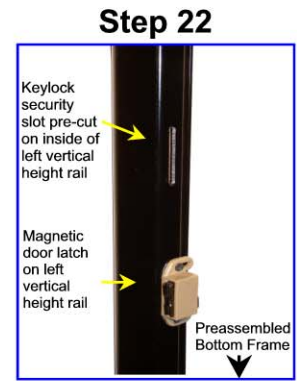

**Step 22**  
The keylock security slot is pre-cut on the left front vertical height rail as shown above. NOTE: The security slot is positioned "above" the magnetic door latch. Also, note the direction of arrow pointing down toward bottom frame. Door stays closed with magnetic door latch and locks securely with cam lock mechanism (see Step 23).



**Step 23**  
Place key in front door frame key lock, close door until flush with vertical rails and turn key to securely lock door.



**Step 24**  
For a secure fit each acrylic panel has 2 foam strips attached. These are positioned on the inside edges of all 3 acrylic panels in your kit.

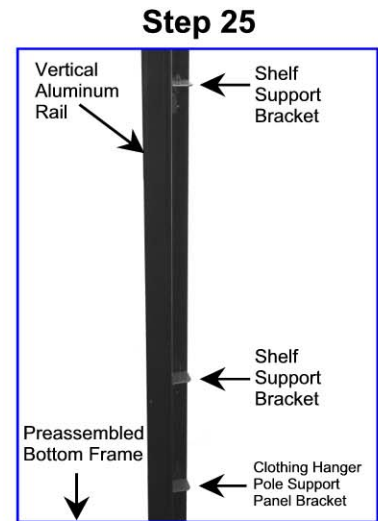

**IMPORTANT NOTE!!**

All vertical aluminum rails have pre-installed support brackets positioned in their upper half. When installing the 4 vertical aluminum rails, be sure these brackets are in the upper half of the rail. THIS IS VERY IMPORTANT AND WILL AVOID HAVING TO DISASSEMBLE AND REASSEMBLE YOUR WARDROBE CLOSET.

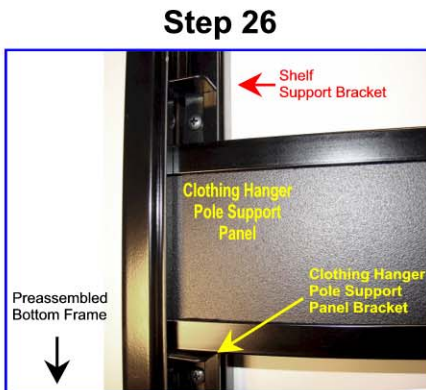

**Step 26**  
Install wardrobe pole hanging support panel between 2 lower support brackets & into 1/2" opening in aluminum extrusion in both front & rear vertical rails on left and right side as shown.



Your Designer Series Wardrobe Closet Organizer/Storage System is now fully assembled and operational.